

BABCONNECTOR

Wire-to-wire, Wire-to-unit

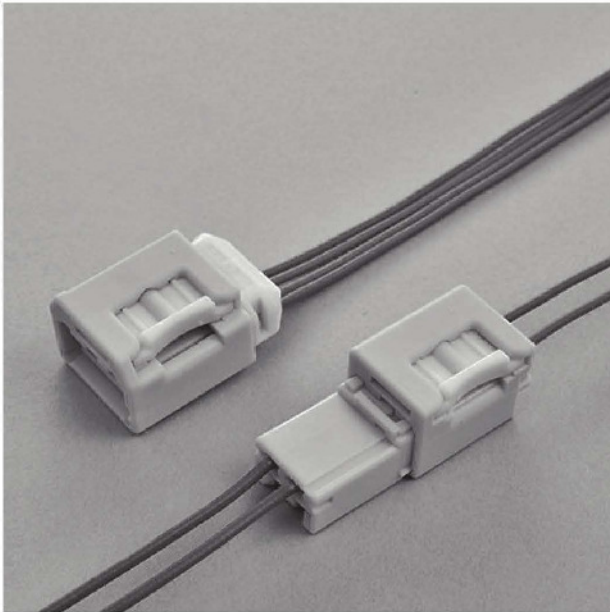

0.64 mm wire-to-wire and wire-to-unit connector with rigid design and spring lock mechanism.

Spring force prevents half-mating during mating and keeps constant rigid connection between male and female connectors.

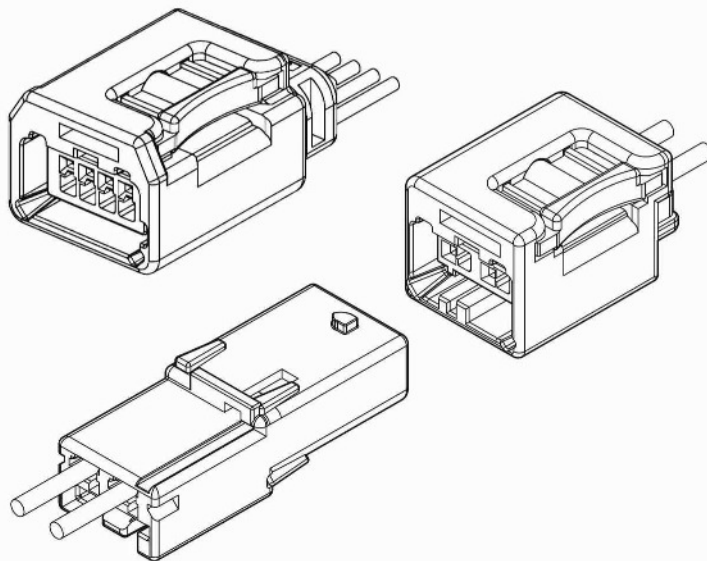

Features

- **Go / No-Go Mating System**
Compression spring prevents half-mating.
- **Anti Vibration Mechanism**
High reliability rigid connector enables to keep higher durability at shock and vibration environment.
- **Compact size**

Specifications

- Current rating: 3 A AC, DC max. (0.3 mm²)
5 A AC, DC max. (0.5 mm²)
- Withstanding voltage: 1,000 VAC/minute
- Temperature range: -40°C to +80°C
(including temperature rise in applying electrical current)
- Contact resistance: Initial value/ 10 mΩ max.
After environmental tests/ 20 mΩ max.
- Insulation resistance: 100 MΩ min.
- Applicable wire: AVSS
0.3 mm² to 0.5 mm²

* Compliant with ELV/RoHS2.

* Contact IEC for details.

BAB CONNECTOR

Female terminal

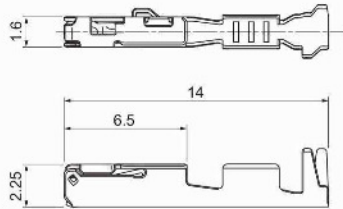

Model No.	Applicable wire range		Q'ty/reel
	Conductor (mm ²)	Insulation O.D. (mm)	
① SAIT-A03T-M064	0.3 to 0.5	≤1.9	6,500
② SAIT-A03GF-M064	0.3 to 0.5	≤1.9	6,500

Material and Finish

- ① Copper alloy, tin-plated (reflow treatment)
- ② Copper alloy, nickel-undercoated, Contact area; gold-plated Barrel area; tin-plated

Female connector

● 2 circuits

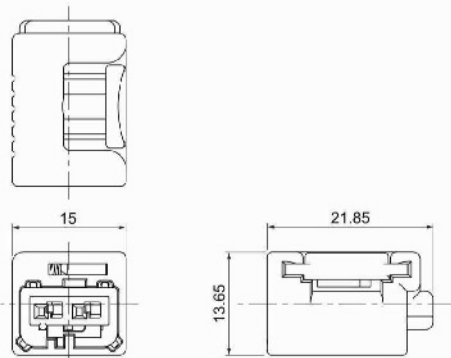

● 4 circuits

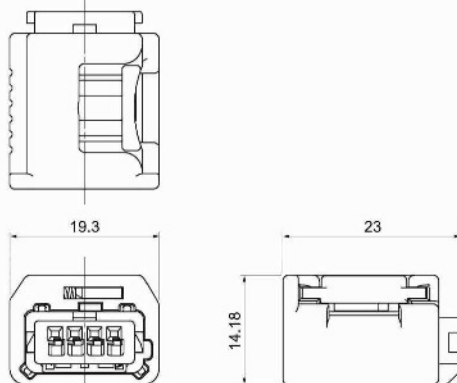

Circuits	Model No.	Q'ty/box
2	BABRB-02-1A-Y()	300
4	BABRB-04-1A-Y	300

Material and Finish

Housing: Glass-filled PA, Yellow
 Retainer: Glass-filled PBT, Natural
 Slider: Glass-filled PBT, Natural
 Spring: SUS

Note: Key codes other than above-mentioned housing are also available.
 Contact JST for details.

Male terminal

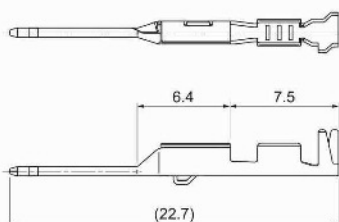

Model No.	Applicable wire range		Q'ty/reel
	Conductor (mm ²)	Insulation O.D. (mm)	
① SAITW-A03T-064	0.3 to 0.5	≤1.9	9,000
② SAITW-A03GF-064	0.3 to 0.5	≤1.9	9,000

Material and Finish

- ① Brass, tin-plated (reflow treatment)
- ② Brass, nickel-undercoated, Contact area; gold-plated Barrel area; tin-plated

BAB CONNECTOR

Male connector

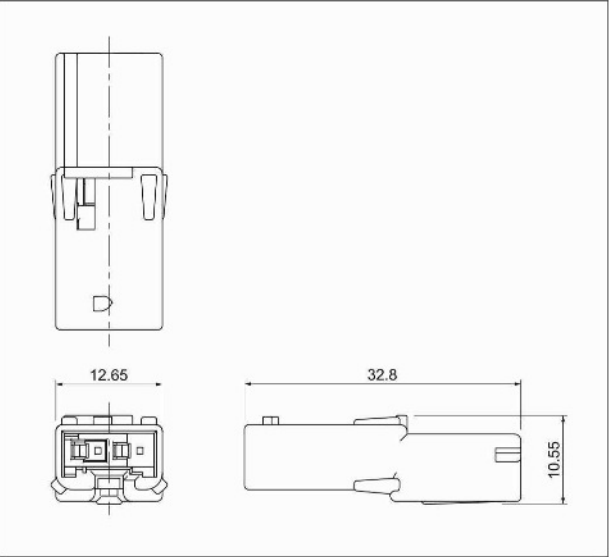

Circuits	Model No.	Q'ty/box
2	BABPB-02-1A-Y()	300

Material and Finish

Housing: PA, Yellow
Retainer: PBT, Natural

Note: Key codes other than above-mentioned housing are also available.
Contact JST for details.

Wire cover

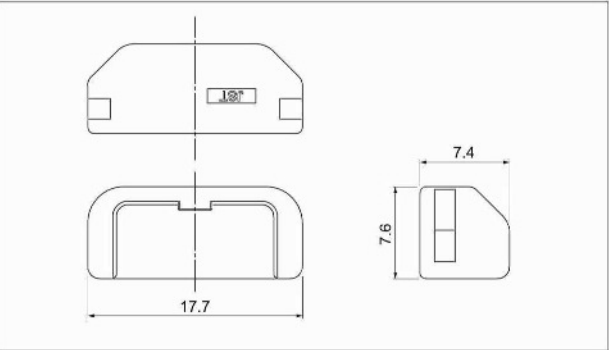

Model No.	Q'ty/box
Note) BABWC-04-1A-S	1,000

Material and Finish

Glass-filled PBT, Natural

Note: Cover is applicable only for 4 circuits.
Cover is an optional part.

Assembly layout

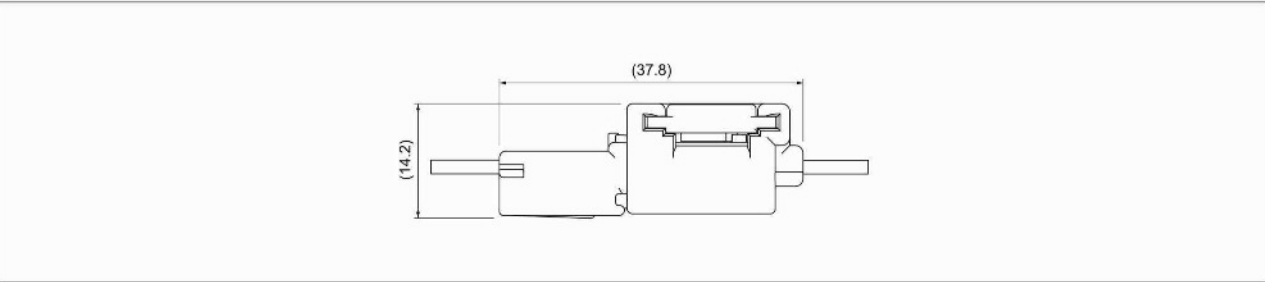

Crimping machine, Applicator

Strip terminal	Crimping machine	Crimp applicator MKS-L	
		Dies	Crimp applicator with dies
SAIT-A03()-M064	AP-K2N	MK/SAIT-A03-064	APLMK SAIT-A03-064
SAITW-A03()-064		MK/SAITW-A03-064	APLMK SAITW-A03-064

Note: 1. When crimping operation is conducted using an applicator and die set other than the above,
JST cannot guarantee the performance of the terminal.
2. Contact JST for details.