

# HTB CONNECTOR

**0.635mm pitch/Board-to-board connectors**

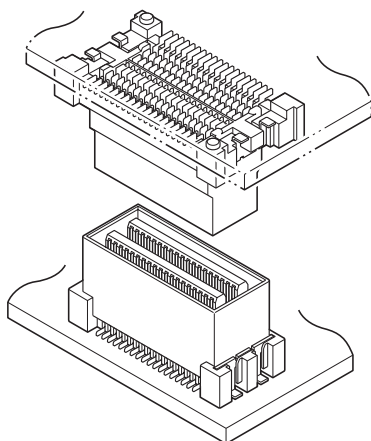

***This connector is 0.635mm pitch SMT type board-to-board connector with parallel and perpendicular connection.***

- ***Distortion preventive construction***
- ***High contact reliability***
- ***Absorbing misalignment when mating connector***

## Specifications

- Current rating: 0.5A AC, DC
- Voltage rating: 50V AC, DC
- Temperature range: -55°C to +85°C  
(including temperature rise in applying electrical current)
- Contact resistance: Initial value/70m Ω max.  
After environmental testing/100m Ω max.
- Insulation resistance: Initial value/ 50m Ω min.
- Withstanding voltage: Initial value/ 500V AC/minute
- \* Compliant with RoHS.
- \* Refer to "General Instruction and Notice when using Terminals and Connectors" at the end of this catalog.
- \* Contact JST for details.

## PC board layout (viewed from component side)

### Receptacle Top entry type

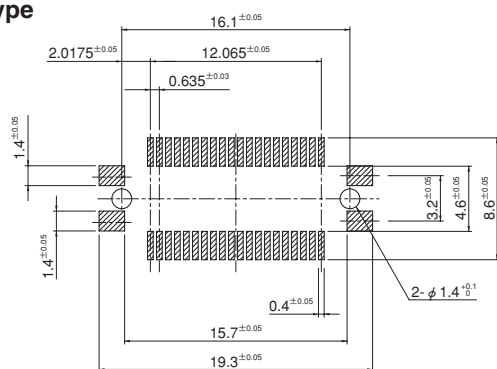

### Receptacle Side entry type

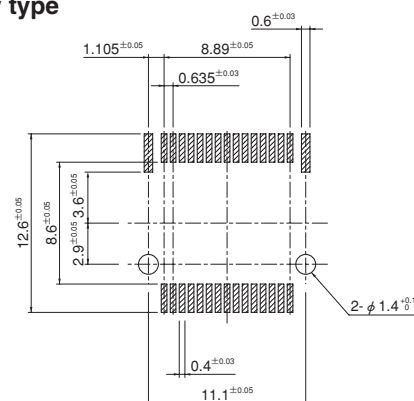

### Shrouded header

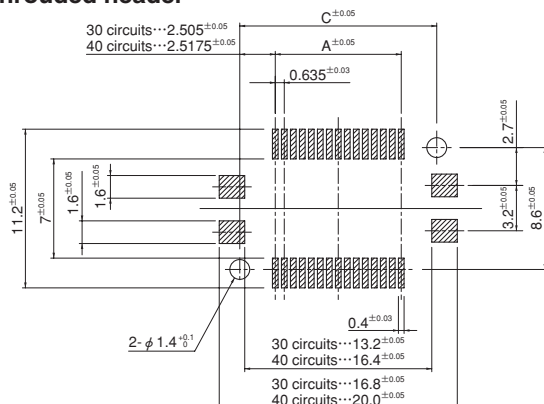

# HTB CONNECTOR

## Assembly layout

### Top entry type

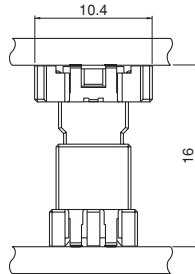

### Side entry type

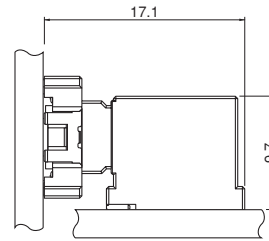

## Receptacle

### Top entry type

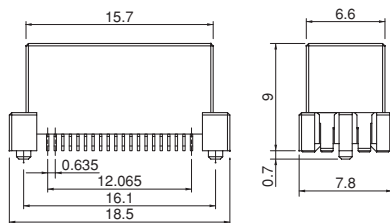
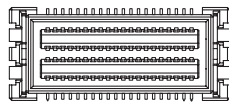

### Side entry type

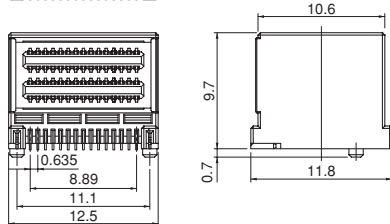
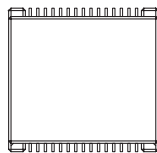

| Circuits | Model No.                               |                        | Q'ty / reel |
|----------|---|------------------------|-------------|
|          | Top entry type (Between PC boards 16mm) | Side entry type        |             |
| 30       | —                                       | <b>30RS-HTBK-06-TF</b> | 250         |
| 40       | <b>40R16-HTBK-06-TF</b>                 | —                      | 300         |

### Material and Finish

Contact: Copper alloy, nickel-undercoated, selective gold-plated  
Housing: Glass-filled PA 9T, UL94V-0  
Reinforcement: Copper alloy, nickel-undercoated, selective gold-plated

### RoHS compliance

Note: This products listed above are supplied on embossed-tape.

## Shrouded header

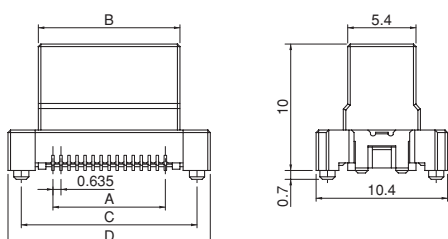
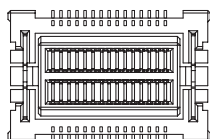

| Circuits | Model No.             | Dimensions (mm) |      |      |      | Q'ty / reel |
|----------|-----------------------|-----------------|------|------|------|-------------|
|          |                       | A               | B    | C    | D    |             |
| 30       | <b>30H-HTBK-06-TF</b> | 8.89            | 11.2 | 13.9 | 16.0 | 250         |
| 40       | <b>40H-HTBK-06-TF</b> | 12.065          | 14.4 | 17.1 | 19.2 | 250         |

### Material and Finish

Contact: Copper alloy, nickel-undercoated, selective gold-plated  
Housing: Glass-filled PA 9T, UL94V-0  
Reinforcement: Copper alloy, nickel-undercoated, selective gold-plated

### RoHS compliance

Note: This products listed above are supplied on embossed-tape.